

SOLAR POWER LOCATION AND CONSTRUCTION PERMIT

CARROLL COUNTY PLANNING & ZONING

114 East 6th St., Carroll, Iowa 51401

Phone (712) 792-1022 FAX (712) 775-2145

Type of Application: Residential: _____ Solar Garden: _____ Utility Scale: _____

Phone Number (____) ____ - _____

Applicant Name: _____

Address: _____ City: _____ State: _____ Zip: _____

Contractor Name: _____

City: _____ State: _____ Zip: _____ Phone Number (____) ____ - _____

Location (Legal Description) _____ Parcel ID# _____

Is the proposed solar power array located in any of the following?

- An "Agricultural Area" consisting of over 300 acres and approved by the County Board of Supervisors per Iowa Code 352.6
- Within 2 Miles of Carroll or Glidden City Limits
- In an Unincorporated Community, Such as Mt. Carmel, Maple River or Roselle
- Flood Plain
- Within the Airport Airspace Overlay (see attached map)

Zoning District Designation for proposed Solar Power Array: _____

Type of Array: Building Mounted: _____ Roof Mounted: _____ Ground Mounted: _____

Solar Easement with adjoining property owners needed? Yes: _____ No: _____ (If yes, provide a copy of the agreement)

Solar Garden or Utility Scale Arrays only:

Indicate if the following information is attached to the Application (Criteria contained in Section 14.15.070 Carroll County Zoning Ordinance):

Site Plan			
Number, Location & Spacing of Panels/Arrays	<input type="radio"/> Yes	<input type="radio"/> No	<input type="radio"/> Not Applicable <u>Ref: 14.15.070.02.3.A</u>
Planned Location of Underground or Overhead Lines	<input type="radio"/> Yes	<input type="radio"/> No	<input type="radio"/> Not Applicable <u>Ref: 14.15.070.02.3.B</u>
Project Development Timeline	<input type="radio"/> Yes	<input type="radio"/> No	<input type="radio"/> Not Applicable <u>Ref: 14.15.070.02.3.C</u>
Interconnection Agreement	<input type="radio"/> Yes	<input type="radio"/> No	<input type="radio"/> Not Applicable <u>Ref: 14.15.070.02.3.D</u>
Decommissioning Plan	<input type="radio"/> Yes	<input type="radio"/> No	<input type="radio"/> Not Applicable <u>Ref: 14.15.070.02.5</u>
Grading Plan	<input type="radio"/> Yes	<input type="radio"/> No	<input type="radio"/> Not Applicable <u>Ref: 14.15.070.02.4.D</u>
Aviation Protection	<input type="radio"/> Yes	<input type="radio"/> No	<input type="radio"/> Not Applicable <u>Ref: 14.15.070.02.4.F</u>
Signage	<input type="radio"/> Yes	<input type="radio"/> No	<input type="radio"/> Not Applicable <u>Ref: 14.15.070.02.4.J</u>
Fencing	<input type="radio"/> Yes	<input type="radio"/> No	<input type="radio"/> Not Applicable <u>Ref: 14.15.070.02.4.K</u>

Construction Start Date ____/____/____ Estimated Completion Date ____/____/____

I certify under penalty of perjury and pursuant to the laws of the state of Iowa that this application is true and correct.

Signature of Applicant: _____ Date: _____

Approved Disapproved

Date _____

Signature _____

Permit Number _____ Fee: _____

Reason for Denial (if necessary) _____

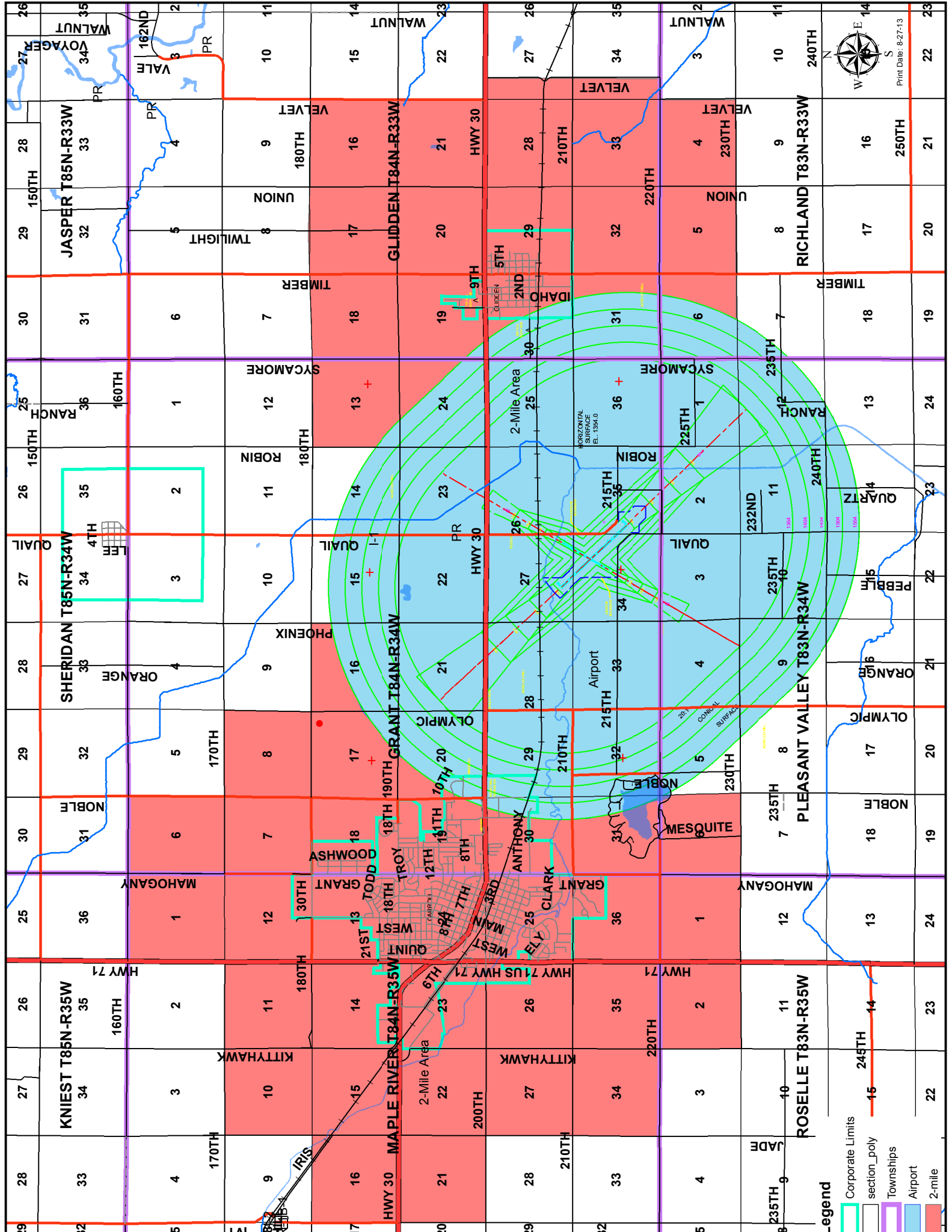

- Legend**
- Corporate Limits
 - section_poly
 - Townships
 - Airport
 - 2-mile



Print Date: 8-27-13